

# eMOPA 266-40

Diode pumped passively Q-switched solid state laser

- 266 nm
- Single Pulse
- < 1.0 ns
- single shot (pulse on demand) – 1 kHz
- > 40  $\mu$ J
- External / Internal Trigger



biology · biomedicine · chemistry · analytics

<b>Optical Data</b>	Wavelength	266 nm
	Peak Power	> 40 kW @ 1000 Hz
	Pulse Energy	> 40 $\mu$ J @ 1000 Hz
	Beam Divergence (full angle)	< 1.5 mrad
	Beam Ellipticity	< 1.5:1
	Beam Diameter	0.8 $\pm$ 0.3 mm (at laser exit)
	Spatial Mode	TEM <sub>00</sub>
	Pulse Repetition Rate (with external trigger)	single shot (pulse on demand) – 1 kHz
	Pulse Width (FWHM)	< 1.0 ns
	Polarization Ratio	> 100:1, vertical
	Pulse Energy Drift over 6h <sup>1)</sup>	< $\pm$ 3 %
	Pulse-to-Pulse Energy Stability <sup>2)</sup>	< 2%
	Laser Classification	4 / IV
<b>Optical Output</b>	Free Beam	
<b>Electrical Data</b>	Electrical Power Consumption	< 100 W
	Line Voltage	90 - 265 V AC (50-60 Hz)
<b>Interface</b>	USB / RS232	
	BNC connector for external triggering (TTL)	
	SMB connector for 24 V DC output	
<b>Miscellaneous</b>	Warm-up Time	< 10 min
	Operating Temperature	22 - 32 °C
	Laser Head Size	56 x 140 x 265 mm (H x W x L)
	Stand-Alone Unit Size	129.5 x 177 x 180 mm (H x W x L)
<b>Options</b>	Multimode fiber coupling	
	Synchronization signal output (rise time < 1.5 ns)	
	Electrical or manual wavelength switch (266nm – 532nm) or electrical beam blocker	
	External telescope (beam expander)	

<sup>1)</sup> Averaged over 10s after 10min of continuous operation @ 1kHz activated closed loop control

<sup>2)</sup> Over 1000 pulses @ 1kHz after 10min of continuous operation

## Dimensions

Laser Head:

265 x 140 x 56 mm

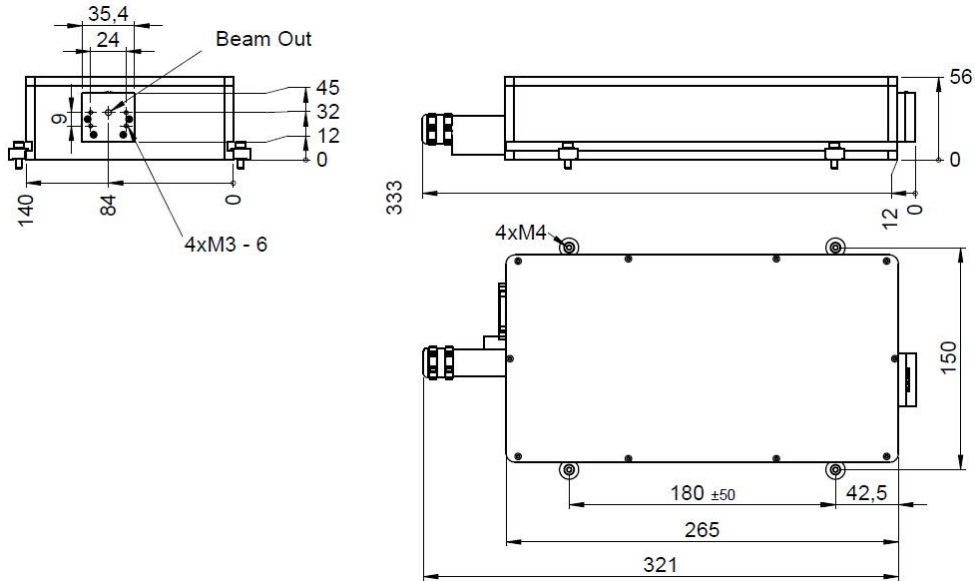

Controller OEM:

166 x 144 x 105 mm

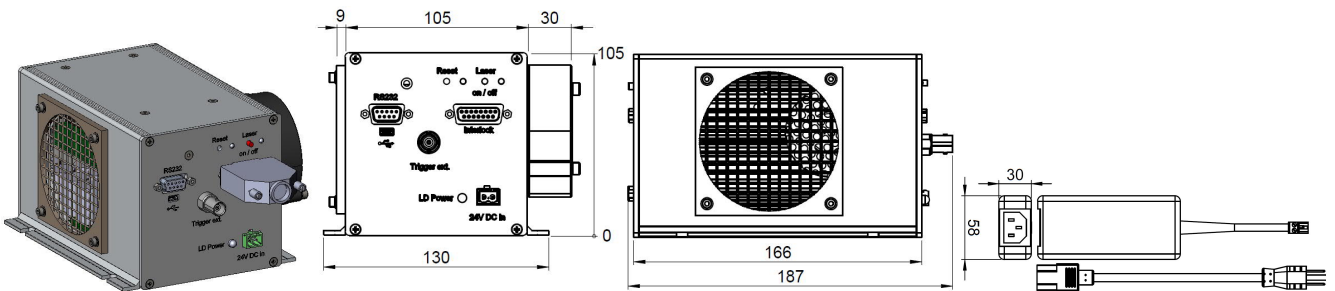

Controller Stand-Alone:

180 x 177 x 129.5 mm

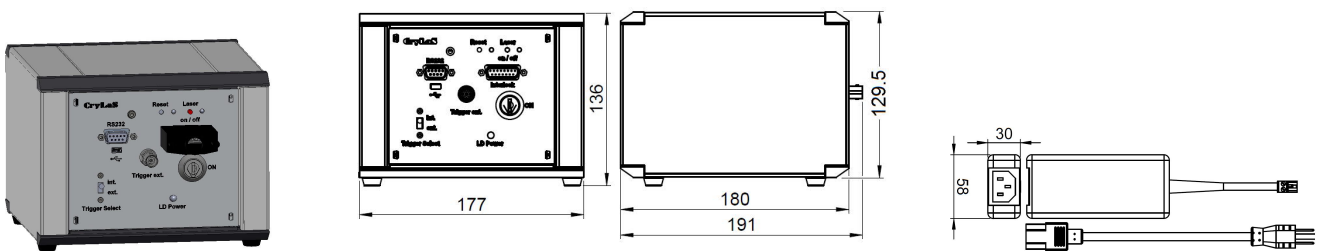

## Laser Safety Labels

The eMOPA 266-40 lasers are class 4 according to IEC 60825-1

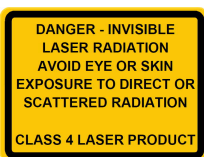
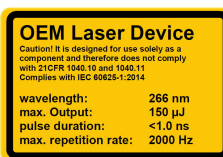

© Jan. 2019, Rev 1.2, CryLaS GmbH. All rights reserved.  
Product specifications are subject to change without notice